

## Panel & Mesh Gaskets 8

12-106M

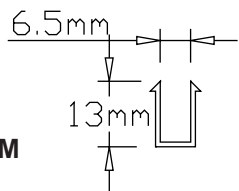

12-106

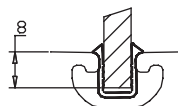

12-107

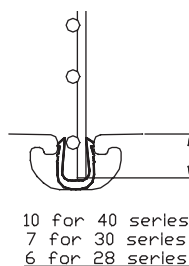

### Application

Panel gasket fits 6mm panels. Mesh gasket for 12 Gage wire mesh. Both for use on 40, 30 and 28 series profiles.

### Technical Data

Molded vinyl, grey  
Weight 40 g/m

12-107M

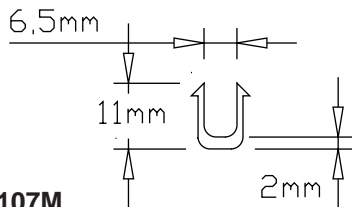

**Description**  
Panel Gasket 8

**Unit**  
cut off max. 30.5M  
30.5m roll

**Part #**  
12-106M  
12-106R

Mesh Gasket 8

cut off max. 30.5M  
30.5m roll

12-107M  
12-107R

## Panel Gasket 10

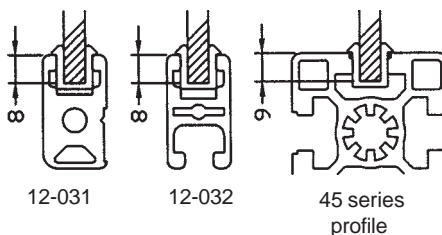
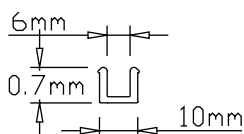

### Application

Flexible vinyl gasket for use in 10mm T-slots of 32x18 profiles and 45 series profiles. Holds 6mm (1/4") panels.

### Technical Data

Clear vinyl  
Weight 90 g/m

**Description**  
Vinyl Panel Gasket 10

**Unit**  
cut off max. 125m

**Part #**  
12-108

## Safety Cover

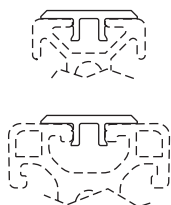
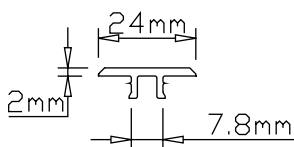

### Application

For caution areas of 40, 30 or 28 series guards and enclosures.

### Technical Data

Rigid PVC, yellow  
Weight 0.3 kg

**Description**  
Safety Cover Strip

**Unit**  
1 pc at 3M

**Part #**  
12-112

## Anti-Skid Cover

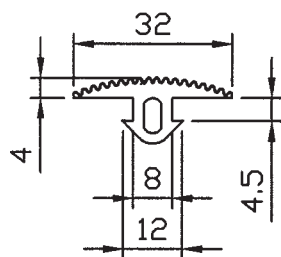

### Application

Cover for 40 series profiles only, is used for non-slip surfaces such as ladders and stops for sliding doors. Oil and water resistant.

### Technical Data

Rubber, black  
Hardness 80 shore  
Weight 180 g/m

**Description**  
Anti-Skid Cover 40

**Unit**  
cut off max. 20M

**Part #**  
12-114

**T-Slot Cover**

12-101

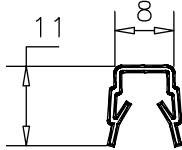

1



2

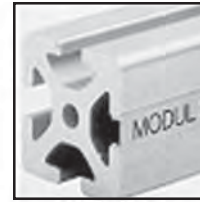

3

12-103

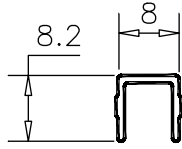

- 1 Entire T-slot cross section can be utilized as a raceway for wiring and piping
- 2 Aluminum cover strip is easily cut off with tin snips. See services and tools
- 3 Engraved information plates can be made from segments
- 4 Cover/gasket strip used as a T-slot cover
- 5 Cover/gasket strip used as a gasket

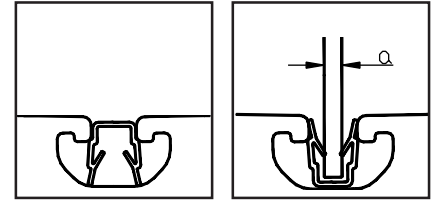

4

5

a = max 1.5-2mm (20 series)  
a = 4-6mm (40 series)  
a = 6mm (28,30 series)

12-115

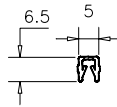

**Application**

Dust-tight covers and gaskets for all IPS profiles. Covers provide flush surfaces, making the entire T-slot available as conduit for wiring and piping. Aluminium covers are easily engraved.

**Technical Data**

Cover/gasket: Polypropylene, semi-clear, black or yellow

PVC cover, black or blue

Aluminum cover, clear or black anodized

12-111B

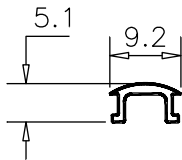

12-116B

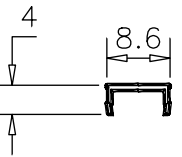

17-111B

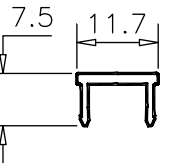

12-102

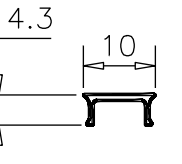

12-104

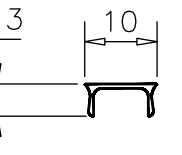

**Description**

Cover/Gasket Strip 40

**Unit**

1 pc at 2M

**Weight**

52 g

**Color**

clear  
black  
yellow

**Part #**

12-101  
12-101B  
12-101Y

Cover/Gasket Strip 28

1 pc at 2M

33 g

clear  
black  
yellow

12-103  
12-103B  
12-103Y

Cover/Gasket Strip 20

1 pc at 2M

27 g

clear  
black

12-115  
12-115B

PVC Cover Strip 40

1 pc at 2M

44 g

black  
blue

12-111B  
12-111BL

PVC Cover Strip 30/28

1 pc at 2M

27 g

black

12-116B

PVC Cover Strip 45

1 pc at 2M

59 g

black

17-111B

Aluminum Cover Strip 40

1 pc at 2M

50 g

clear  
black

12-102  
12-102B

Aluminium Cover Strip 30/28

1 pc at 2M

35 g

clear  
black

12-104  
12-104B

Inquire about quantity discounts



# End Caps

## Application

For covering the ends of profiles after application assembly.

## Technical Data

Glass-filled nylon, black

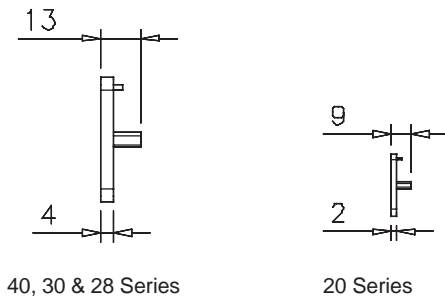

40, 30 & 28 Series

20 Series

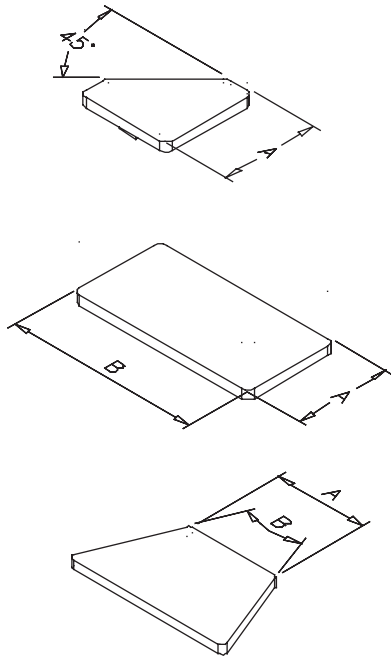

## Description (Size AxB)

### 40 Series

- 40x40
- 40x40 Heavy Square
- 40x40 Quarter Round
- 80x40
- 40x100
- 80x80
- 40x120
- 80x120
- 16x40
- 16x80
- 16x160
- 160x28
- 160x40
- 160x80
- 40x40-45°
- 40-45°
- 40-60°
- 50x50

### 30 Series

- 30x30
- 30x60
- 60x60

### 28 Series

- 28x28
- 28x56
- 28x28-45°

### 20 Series

- 20x10
- 20x20
- 20x40
- 40x40, 20 series
- 20x60
- 20x80
- 80x14
- 7mm Access Hole Plug

## Unit

## Weight (g)

## Part #

1 pc	7	18-813
1 pc	10	18-805
1 pc		18-843
1 pc	15	18-814
1 pc	20	18-804
1 pc	28	18-815
1 pc	22	18-840
1 pc	43	18-841
1 pc	4	18-811
1 pc	6	18-812
1 pc	10	18-806
1 pc	20	18-816
1 pc	28	18-817
1 pc	66	18-818
1 pc	6	18-820
1 pc		18-845
1 pc		18-860
1 pc	10	18-810
1 pc		18-803
1 pc		18-863
1 pc		18-866
1 pc	4	18-808
1 pc	8	18-809
1 pc		18-844
1 pc	0.5	18-830
1 pc	1	18-802
1 pc	2	18-831
1 pc	4	18-832
1 pc	3	18-834
1 pc	4	18-835
1 pc	3	18-833
1 pc		18-710

# Secure End Cap

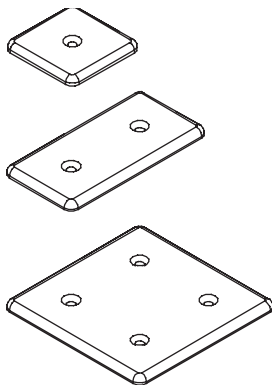

See Conduit section for Conduit Caps

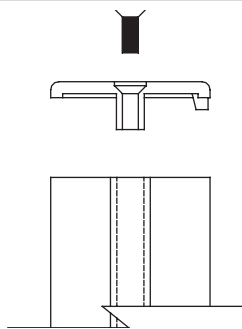

## Application

Used for covering the ends of profiles. End cap can be additionally secured with M4x12 flat head screw (order separately) and can be re-used after screw removed. No profile servicing is required.

## Technical Data

Glass-filled nylon, black  
Screw - St., black oxide

## Description

- Secure End Cap 40x40
- Secure End Cap 40x80
- Secure End Cap 80x80
- Secure End Cap 56x56
- M4x12 Flat Head Cap Screw

## Unit

## Weight

## Part #

1 pc	7 g	18-913
1 pc	23 g	18-914
1 pc	26 g	18-915
1 pc		18-919
pkg of 100		24-212-4